



SPACIOUS & WELL-PRESENTED SECOND FLOOR APARTMENT WITH ALLOCATED PARKING & COMMUNAL GARDENS

Mill Stream Lodge, Uxbridge Road, Rickmansworth, Hertfordshire, WD3 8JQ

ROBSONS

Mill Stream Lodge, Uxbridge Road, Rickmansworth,
Hertfordshire, WD3 8JQ

**RECEPTION ROOM • KITCHEN • PRINCIPAL
BEDROOM WITH EN-SUITE • SECOND
BEDROOM • FAMILY BATHROOM •
ATTRACTIVE COMMUNAL GARDENS •
ALLOCATED PARKING • RESIDENTS
PARKING**

Description

This spacious and well-presented two-bedroom,
two-bathroom second-floor apartment is ideally positioned
within a highly sought-after development, enjoying attractive
views over beautifully maintained communal gardens.

The property comprises a welcoming hallway with two useful
storage cupboards, leading through to a generous reception
room featuring a charming bay window that allows for plenty
of natural light. The kitchen is well-equipped with a good
range of fitted units, an integrated oven, and space for
freestanding appliances.





The principal bedroom benefits from an en-suite shower room, while a second well-proportioned bedroom is served by a separate family bathroom.

Externally, the apartment is set within well-kept communal grounds and further benefits from an allocated parking space, as well as additional residents' parking.

Location

Rickmansworth town centre has a wide range of boutique shops, coffee houses, restaurants and major supermarkets. The Metropolitan and Chiltern line train services connect you to London Baker Street, Marylebone Station and beyond. The area is well served for good quality private and state schools for all ages. Chorleywood and Rickmansworth offer everything for the sporting individual.

Additional Information

Tenure: Leasehold

Local Authority: Three Rivers District Council

Council Tax Band: D

Energy Efficiency Rating: C

Lease Term: 97 Years Remaining

Service Charge: £2,875 pa

Ground Rent: £600.00 pa

For additional information, please refer to www.robsonsworld.com or call us on: 01923 777762.



Approximate Gross Internal Area = 59.4 sq m / 639 sq ft

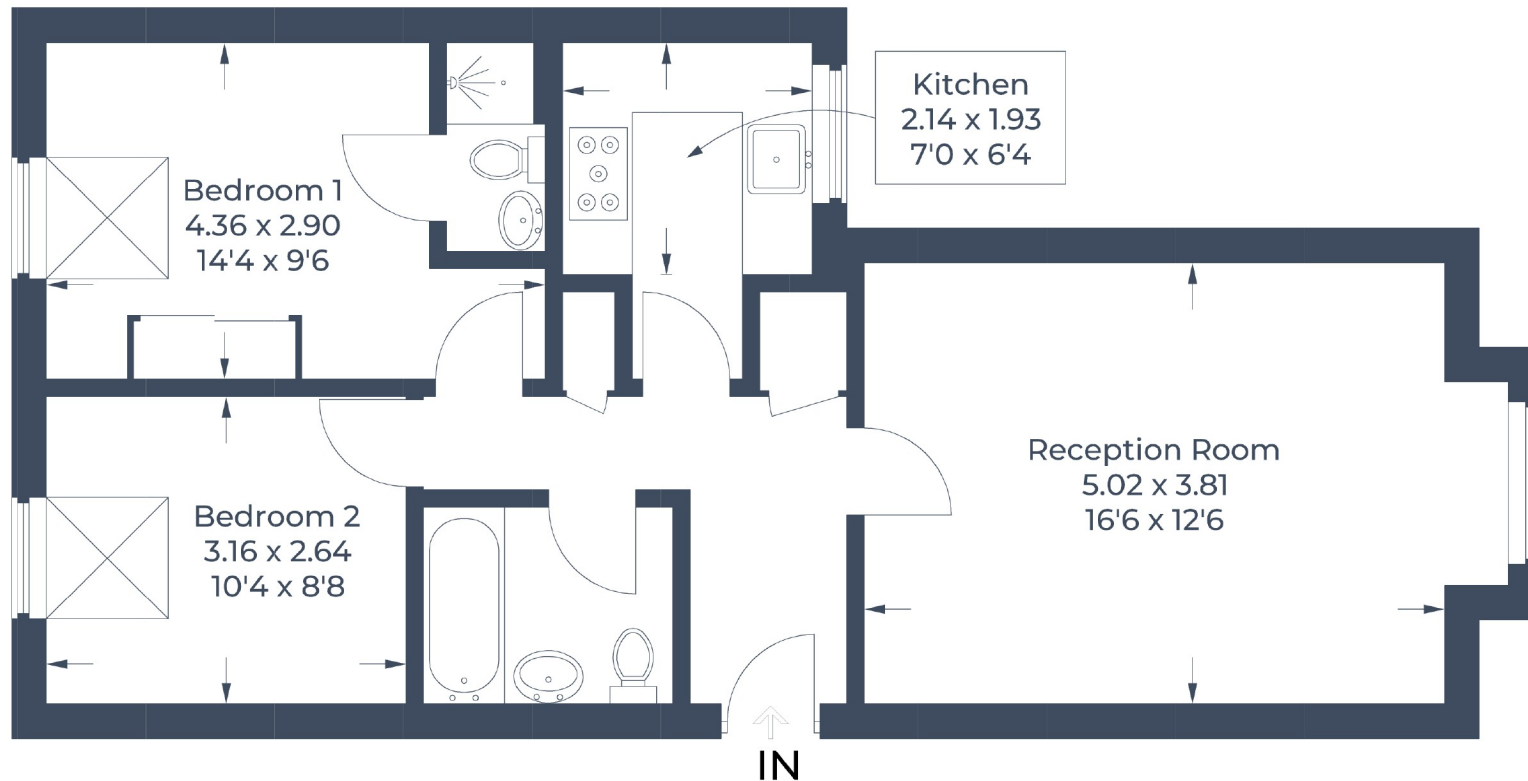

Second Floor

Illustration for identification purposes only,
measurements are approximate, not to scale.

© CJ Property Marketing

ROBSONS

130 High Street, Rickmansworth WD3 1AB

Tel: 01923 777762 Email: rickmansworth@robsonswb.com

www.robsonswb.com

SCAN TO VISIT



OUR WEBSITE

Important notice: Robsons, their clients and any joint agents give notice that 1: They are not authorised to make or give any representations or warranties in relation to the property either here or elsewhere, either on their own behalf or on behalf of their client or otherwise. They assume no responsibility for any statement that may be made in these particulars. These particulars do not form part of any offer or contract and must not be relied upon as statements or representations of fact. 2: Any areas, measurements or distances are approximate. Plot sizes and dimensions are taken from Promap and are approximate. The text, photographs and plans are for guidance only and are not necessarily comprehensive. It should not be assumed that the property has all necessary planning, building regulation or other consents and Robsons have not tested any services, equipment or facilities. Purchasers must satisfy themselves by inspection or otherwise.