



A DETACHED FOUR BEDROOM FAMILY HOME OCCUPYING A LARGE PLOT

Ormonde Road, Moor Park, HA6 2EL

ROBSONS

Ormonde Road, Moor Park, HA6 2EL

DETACHED • FOUR BEDROOMS • TWO BATHROOMS • TWO RECEPTION ROOMS • KITCHEN • UTILITY ROOM • STUDY • DOWNSTAIRS W/C • REAR GARDEN • DRIVEWAY PARKING & DOUBLE GARAGE

Description

A spacious detached four-bedroom family home occupying a generous plot on the prestigious Moor Park Estate. This well-presented property offers versatile living accommodation throughout and is ideally suited for modern family living. The ground floor comprises a welcoming entrance hall leading to a bright triple-aspect living room, a separate dining room, study, downstairs w/c, and a spacious kitchen/breakfast room with a separate utility room. To the first floor are four well-proportioned bedrooms and a family bathroom with a separate w/c. The main bedroom benefits from an ensuite bathroom complete with his and hers sinks.

Externally, the property enjoys a beautifully maintained rear garden, while to the front there is a spacious driveway providing ample off-street parking and access to the double garage.





Ormonde Road is conveniently located for Moor Park shops, restaurants and the Metropolitan Line train station. Northwood, Rickmansworth and Watford's town centres are also accessible offering a further wide range of shops and restaurants. The local area is well served for state and private schools, which includes Merchant Taylors Junior and Senior Schools which are both on the estate. Leisure facilities include five golf courses, cricket and football clubs as well as fitness centres. Major motorways and airports are also within reach.

Moor Park (1958) Limited is the Company that manages the Moor Park Estate. The role of the Company is to protect and promote the interests of the Members and to preserve the amenities of the Estate. All freehold householders should be members of the Company, limited to one member per household. Membership of the Company entitles the Member to attend General Meetings and vote on any resolutions, such as setting the annual contribution rate. Each household must make annual contribution which is calculated on the linear footage of each property. For further information, please contact Robsons.

Please note the photographs are not current

Additional Information

Tenure: Freehold

Local Authority: Three Rivers

Council Tax Band: H

Energy Efficiency Rating: E

For additional information, please refer to www.robsonswb.com or call us on: 01923 820622.



APPROX. GROSS INTERNAL FLOOR AREA 2757 SQ FT 256.1 SQ METRES (INCLUDES GARAGE)

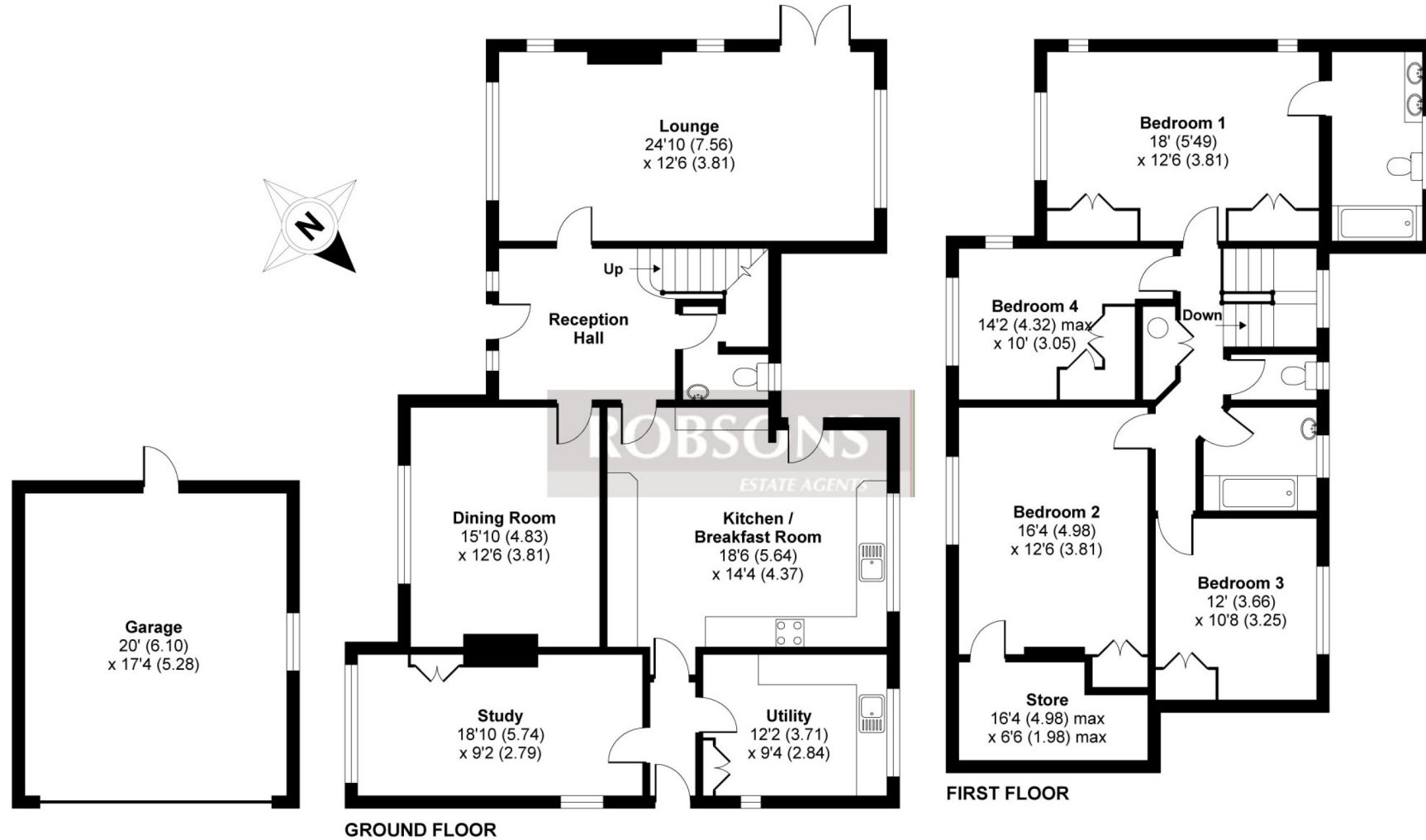

'For illustrative purposes only - not to scale. The position and size of doors, windows, appliances and other features are approximate only.'

Whilst every attempt has been made to ensure the accuracy of the floor plan contained here, measurements of doors, windows and rooms are approximate and no responsibility is taken for any error, omission or misstatement. These plans are for representation purposes only as defined by RICS Code of Measuring Practice and should be used as such by any prospective purchaser. Specifically no guarantee is given on the total square footage of the property if quoted on this plan. Any figure given is for initial guidance only and should not be relied on as a basis of valuation.

Copyright nichecom.co.uk 2014 Produced for Robsons REF : 557980

ROBSONS

North Approach, Moor Park, Northwood HA6 2JQ
Tel: 01923 820622 Email: moorpark@robsonswb.com

www.robsonswb.com

SCAN TO VISIT



OUR WEBSITE

Important notice: Robsons, their clients and any joint agents give notice that 1: They are not authorised to make or give any representations or warranties in relation to the property either here or elsewhere, either on their own behalf or on behalf of their client or otherwise. They assume no responsibility for any statement that may be made in these particulars. These particulars do not form part of any offer or contract and must not be relied upon as statements or representations of fact. 2: Any areas, measurements or distances are approximate. Plot sizes and dimensions are taken from Promap and are approximate. The text, photographs and plans are for guidance only and are not necessarily comprehensive. It should not be assumed that the property has all necessary planning, building regulation or other consents and Robsons have not tested any services, equipment or facilities. Purchasers must satisfy themselves by inspection or otherwise.