



ONE BEDROOM GROUND FLOOR MAISONETTE WITH SHARE OF FREEHOLD & NO ONWARD CHAIN

Windermere Close, Chorleywood, Hertfordshire, WD3 5LF

ROBSONS

Windermere Close, Chorleywood, Hertfordshire,
WD3 5LF

**GROUND FLOOR • LIVING/DINING ROOM •
KITCHEN • BEDROOM • BATHROOM •
COMMUNAL GARDENS • SHARE OF
FREEHOLD • LEASE TERM: 958 YEARS
REMAINING • NO ONWARD CHAIN**

Description

Nestled within the highly sought-after Windermere Close, this well-presented one-bedroom ground floor maisonette offers a fantastic opportunity for first-time buyers, downsizers, or investors alike. Situated in a peaceful cul-de-sac off Hubbards Road, the property is just a short stroll from the heart of Chorleywood village and its array of shops, cafés, and excellent transport links.

Windermere Close is a private development of just 26 purpose-built maisonettes, and this particular home enjoys the added benefits of a share of freehold and no onward chain, ensuring a smooth and flexible purchase.

The accommodation comprises a generous 21'4 x 11'8 front-aspect living/dining room, filled with natural light and complete with a large built-in storage cupboard.





Off the living room, a hallway leads to a well-appointed kitchen, offering a range of fitted units and space for freestanding appliances. The double bedroom benefits from fitted wardrobes, and the fully tiled bathroom features a shower and under-sink storage.

Externally, the property enjoys access to well-maintained communal gardens and convenient off-street parking.

With its prime location, spacious layout, and desirable tenure arrangement, this maisonette is not to be missed.

Location

Chorleywood Village's facilities include a wide choice of shops. The area is also well served for sought after state and private schools for all ages. Leisure facilities include golf courses, cricket, football clubs, horse riding and fitness centres, together with Chorleywood Common. The Metropolitan and Main lines at Chorleywood Station offer a frequent service into London and beyond.

Additional Information

Tenure: Share of Freehold

Local Authority: Three Rivers District Council

Council Tax Band: D

Energy Efficiency Rating: TBC

Lease Term: 958 years remaining

Service Charge: £1,200 pa

For additional information, please refer to www.robsonsworld.com or call us on: 01923 285525.



Approximate Gross Internal Area = 47.0 sq m / 506 sq ft
Outbuilding = 1.0 sq m / 11 sq ft
Total = 48.0 sq m / 517 sq ft

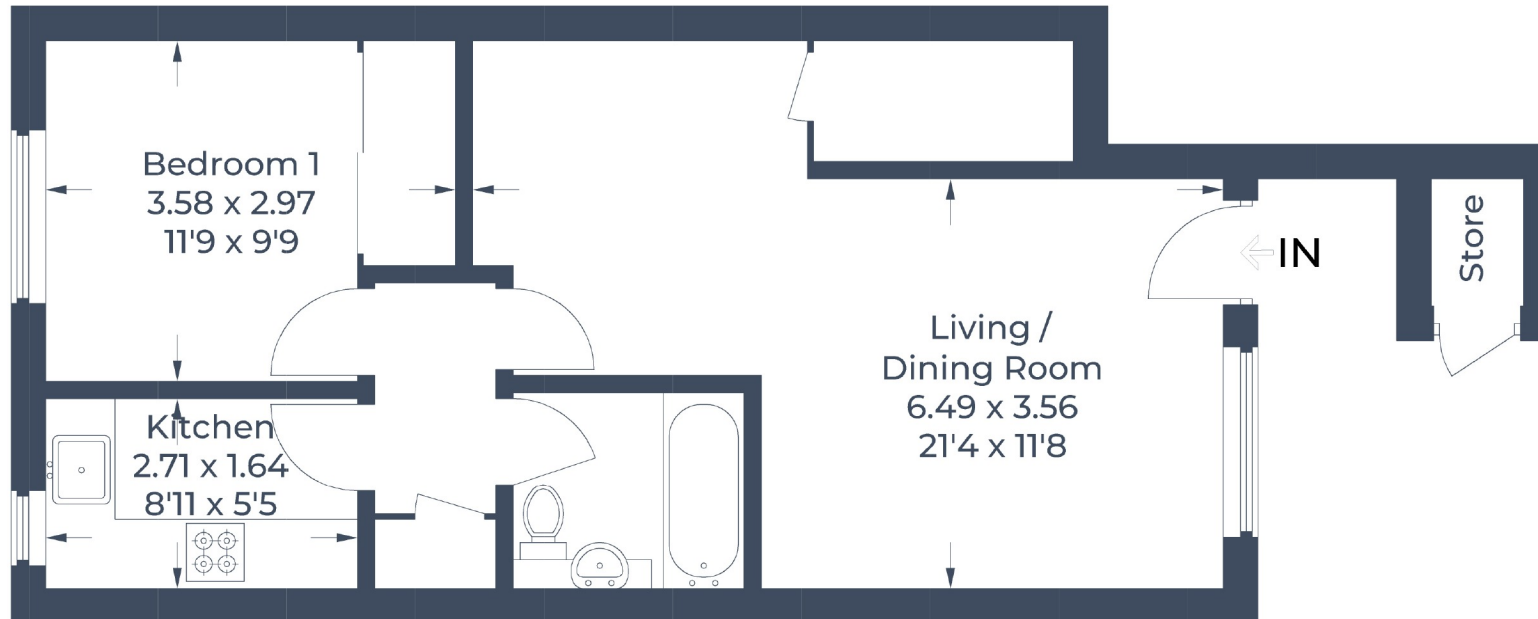

Illustration for identification purposes only,
measurements are approximate, not to scale.
© CJ Property Marketing Produced for Robsons

ROBSONS

2 New Parade, Chorleywood, Hertfordshire, WD3 5NJ
Tel: 01923 285525 Email: chorleywood@robsonswb.com

www.robsonswb.com

SCAN TO VISIT



OUR WEBSITE

Important notice: Robsons, their clients and any joint agents give notice that 1: They are not authorised to make or give any representations or warranties in relation to the property either here or elsewhere, either on their own behalf or on behalf of their client or otherwise. They assume no responsibility for any statement that may be made in these particulars. These particulars do not form part of any offer or contract and must not be relied upon as statements or representations of fact. 2: Any areas, measurements or distances are approximate. Plot sizes and dimensions are taken from Promap and are approximate. The text, photographs and plans are for guidance only and are not necessarily comprehensive. It should not be assumed that the property has all necessary planning, building regulation or other consents and Robsons have not tested any services, equipment or facilities. Purchasers must satisfy themselves by inspection or otherwise.