



A BRIGHT AND WELL-PRESENTED FOUR BEDROOM DETACHED ARTEGAN HOME

Marsworth Avenue, Pinner, HA5 4TT

ROBSONS

Marsworth Avenue, Pinner, HA5 4TT

GUEST CLOAKROOM • THREE RECEPTION ROOMS • KITCHEN/BREAKFAST ROOM • UTILITY ROOM • FOUR BEDROOMS • FAMILY BATHROOM WITH SEPARATE WC • PRIVATE REAR GARDEN • OFF-STREET PARKING • GARAGE

Description

Occupying a generous corner plot overlooking Marsworth Green within the desirable Pinnerwood Park Estate, is this four-bedroom, detached Artegan home providing over 1,700 sq.ft. with an attractive wrap-around rear garden (approx. 70ft), and gated off-street parking. Perfect for families, the property is within easy reach of Pinner Wood and Grimsdyke Primary Schools, as well as local amenities and excellent transport facilities.

The ground floor comprises an entrance hallway with a guest cloakroom, three double-aspect reception rooms, a good-sized kitchen / breakfast room, and a utility room. Four well-appointed bedrooms are located on the first floor, along with a three-piece family bathroom and a separate WC. All four of the bedrooms benefit from fitted wardrobes or storage.





A private rear garden wraps around the property, with a well-maintained lawn and a patio area. Off-street parking is available at the front of the property via your own driveway, along with a garage and a front garden.

Location

Marsworth Avenue is located close to both Hatch End and Pinner High Streets, which both offer a variety of shopping facilities, restaurants, coffee houses and popular supermarkets. For commuters, the Overground is available at Hatch End Station, which provides a regular service to London Euston, with the Metropolitan Line at Pinner Station just a short distance away. Local bus routes are also easily accessible.

The area is well served by primary and secondary schooling, including nearby Pinner Wood and Grimsdyke Primary Schools, as well as a number of children's parks/playgrounds and recreational facilities.

Additional Information

Tenure: Freehold

Local Authority: London Borough of Harrow

Council Tax Band: G

Energy Efficiency Rating: E

For additional information, please refer to www.robsonsworld.com or call us on: 020 8866 8083.



Approximate Gross Internal Area
 Ground Floor = 96.8 sq m / 1,042 sq ft
 First Floor = 61.4 sq m / 661 sq ft
 Total = 158.2 sq m / 1,703 sq ft (Including Garage)

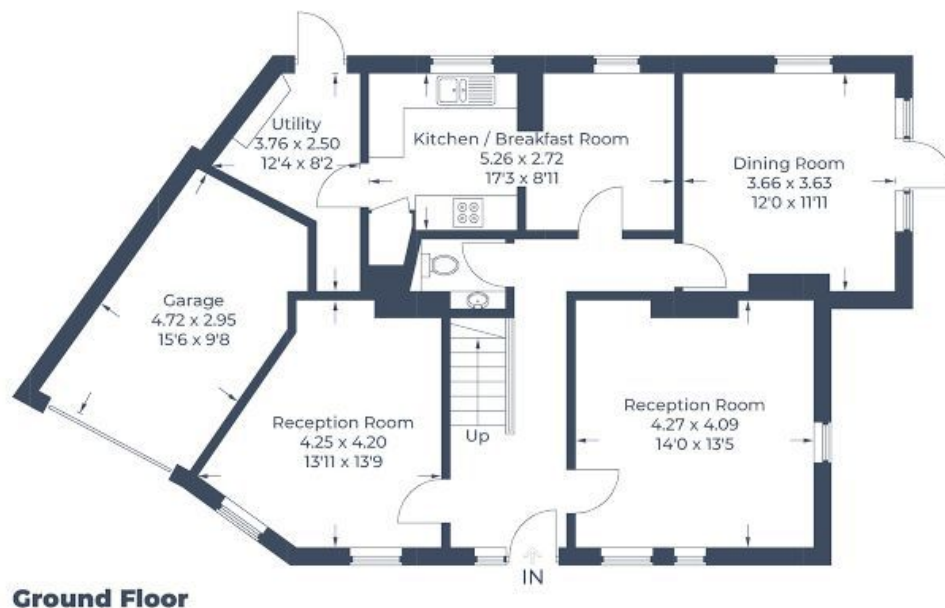

Ground Floor



First Floor

Illustration for identification purposes only,
 measurements are approximate, not to scale.
 © CJ Property Marketing Produced for Robsons

ROBSONS

1 High Street, Pinner HA5 5PJ
 Tel: 020 8866 8083 Email: pinner@robsonswb.com
www.robsonswb.com

SCAN TO VISIT



OUR WEBSITE

Important notice: Robsons, their clients and any joint agents give notice that 1: They are not authorised to make or give any representations or warranties in relation to the property either here or elsewhere, either on their own behalf or on behalf of their client or otherwise. They assume no responsibility for any statement that may be made in these particulars. These particulars do not form part of any offer or contract and must not be relied upon as statements or representations of fact. 2: Any areas, measurements or distances are approximate. Plot sizes and dimensions are taken from Promap and are approximate. The text, photographs and plans are for guidance only and are not necessarily comprehensive. It should not be assumed that the property has all necessary planning, building regulation or other consents and Robsons have not tested any services, equipment or facilities. Purchasers must satisfy themselves by inspection or otherwise.