



A SPACIOUS TWO BEDROOM TWO BATHROOM GROUND FLOOR APARTMENT

Willow Tree Lodge, Eastbury Avenue, Northwood, HA6 3LE

ROBSONS

Willow Tree Lodge, Eastbury Avenue, Northwood,
HA6 3LE

**RECEPTION ROOM • BRAND NEW KITCHEN •
PRINCIPAL BEDROOM WITH EN-SUITE •
FURTHER DOUBLE BEDROOM • FAMILY
BATHROOM • LOVELY COMMUNAL GARDENS
• GARAGE WITHIN THE GATES**

Description

Set within a sought-after area of Northwood, this beautifully presented two bedroom, two bathroom ground floor apartment offers generous living space, modern interiors, and a peaceful setting surrounded by well-maintained communal gardens.

The apartment features a spacious and welcoming hallway complete with a handy storage cupboard. The large, light-filled reception room boasts a charming bay window and offers ample space for both living and dining areas, perfect for relaxing or entertaining guests.

The brand new modern kitchen is stylishly appointed with a range of fitted units and high quality integrated appliances, combining practicality with contemporary design.





Accommodation includes a principal bedroom with fitted wardrobes and a sleek en-suite bathroom, alongside a second double bedroom, also benefiting from fitted wardrobes and a family bathroom

Outside, residents can enjoy the beautifully landscaped communal grounds, ideal for relaxation and recreation. The property also includes an allocated parking space for added convenience.

Location

Northwood provides a range of shopping facilities including Waitrose supermarket, a variety of restaurants and other amenities with the Metropolitan Line station providing access to Baker Street and the City. There is a plethora of state and private schooling together with a wide choice of recreational facilities, which include golf courses and fitness centres. The M1, M40 and M25 motorways are also accessible.

NB this property is situated within the proximity of the ULEZ, if your vehicle does not comply charges may apply.

Additional Information

Tenure: Leasehold

Local Authority: London Borough of Hillingdon

Council Tax Band: F

Energy Efficiency Rating: D

Lease Term: 125 years from June 1991

Service Charge: £2,500 pa

For additional information, please refer to www.robsonsworld.com or call us on: 01923 835355.



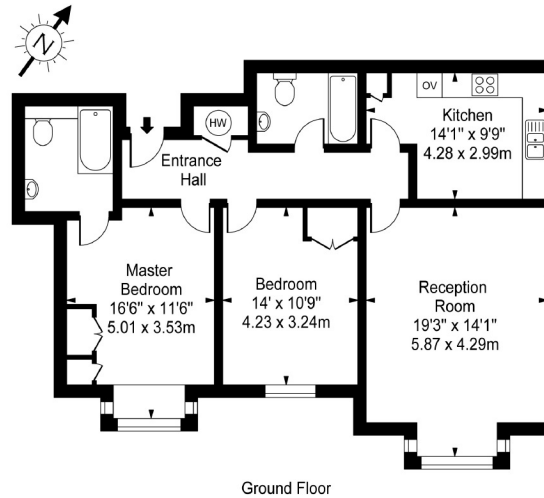

Approx. Gross Internal Area 953 Sq Ft - 88.53 Sq M

For Illustration Purposes Only - Not To Scale Floor Plan by www.pmsupply.co.uk Ref. No. 27290

This floor plan should be used as a general outline for guidance only and do not constitute in whole or in part an offer or contract.
Any intending purchaser or lessee should satisfy themselves by inspection, searches, enquiries and full survey as to the correctness of each statement.
Any areas, measurements or distances quoted are approximate and should not be used to value a property or be the basis of any sale or let.

ROBSONS

7 Clive Parade, Northwood, HA6 2QF

Tel: 01923 835355 Email: northwood@robsonswb.com

www.robsonswb.com

SCAN TO VISIT



OUR WEBSITE

Important notice: Robsons, their clients and any joint agents give notice that 1: They are not authorised to make or give any representations or warranties in relation to the property either here or elsewhere, either on their own behalf or on behalf of their client or otherwise. They assume no responsibility for any statement that may be made in these particulars. These particulars do not form part of any offer or contract and must not be relied upon as statements or representations of fact. 2: Any areas, measurements or distances are approximate. Plot sizes and dimensions are taken from Promap and are approximate. The text, photographs and plans are for guidance only and are not necessarily comprehensive. It should not be assumed that the property has all necessary planning, building regulation or other consents and Robsons have not tested any services, equipment or facilities. Purchasers must satisfy themselves by inspection or otherwise.