



A 4 BEDROOM DETACHED HOME IN A SOUGHT AFTER LOCATION

Woodwaye, Oxhey Hall, Watford, Hertfordshire WD19 4NW

ROBSONS

A 4 BEDROOM HOME IN A SOUGHT AFTER LOCATION

Woodwaye, Oxhey Hall, Watford, Hertfordshire
WD19 4NW

**ENTRANCE HALL • TWO OPEN PLAN
SITTING ROOMS • DINING ROOM •
TWO BATHROOMS • FOUR BEDROOMS •
DETACHED GARAGE • OUTBUILDING • REAR
GARDEN • DRIVEWAY •**

Description

This attractive detached four bedroom, two bathroom family home has been lovingly maintained to a modern standard throughout by the current owners and is positioned conveniently for access to Bushey Main line station. The property has been skilfully and sympathetically extended to the ground floor providing spacious and versatile accommodation.

Externally there is a detached single garage and storeroom to the front of the property with off street parking for multiple vehicles and to the rear, a private and excluded rear garden with summer house.





Location

Oxhey Hall is a beautiful part of Watford, designated as a Conservation Area, containing quiet tree lined roads off Hampermill Lane towards Moor Park and Northwood. The Atria Shopping Centre along with many high street chains, independent shops and supermarkets. There are a number of good schools located in the area and green open spaces are close to hand. Transport facilities include the Metropolitan Line and the main line train station at Bushey is a 10 minute walk offering a frequent service to central London and beyond. The M25 & M1 motorways connect to the national motorway network. Major airports are also within reach.

Additional Information

Tenure: Freehold
Council: Watford
Council Tax Band: G
Energy Efficiency Rating Band: D



Woodway, Watford, Hertfordshire
 Approximate Gross Internal Area
 Main House = 163 Sq M/1754 Sq Ft
 Garage/Outbuilding = 19 Sq M/205 Sq Ft
 Outbuilding = 11 Sq M/118 Sq Ft
 Total = 193 Sq M/2077 Sq Ft

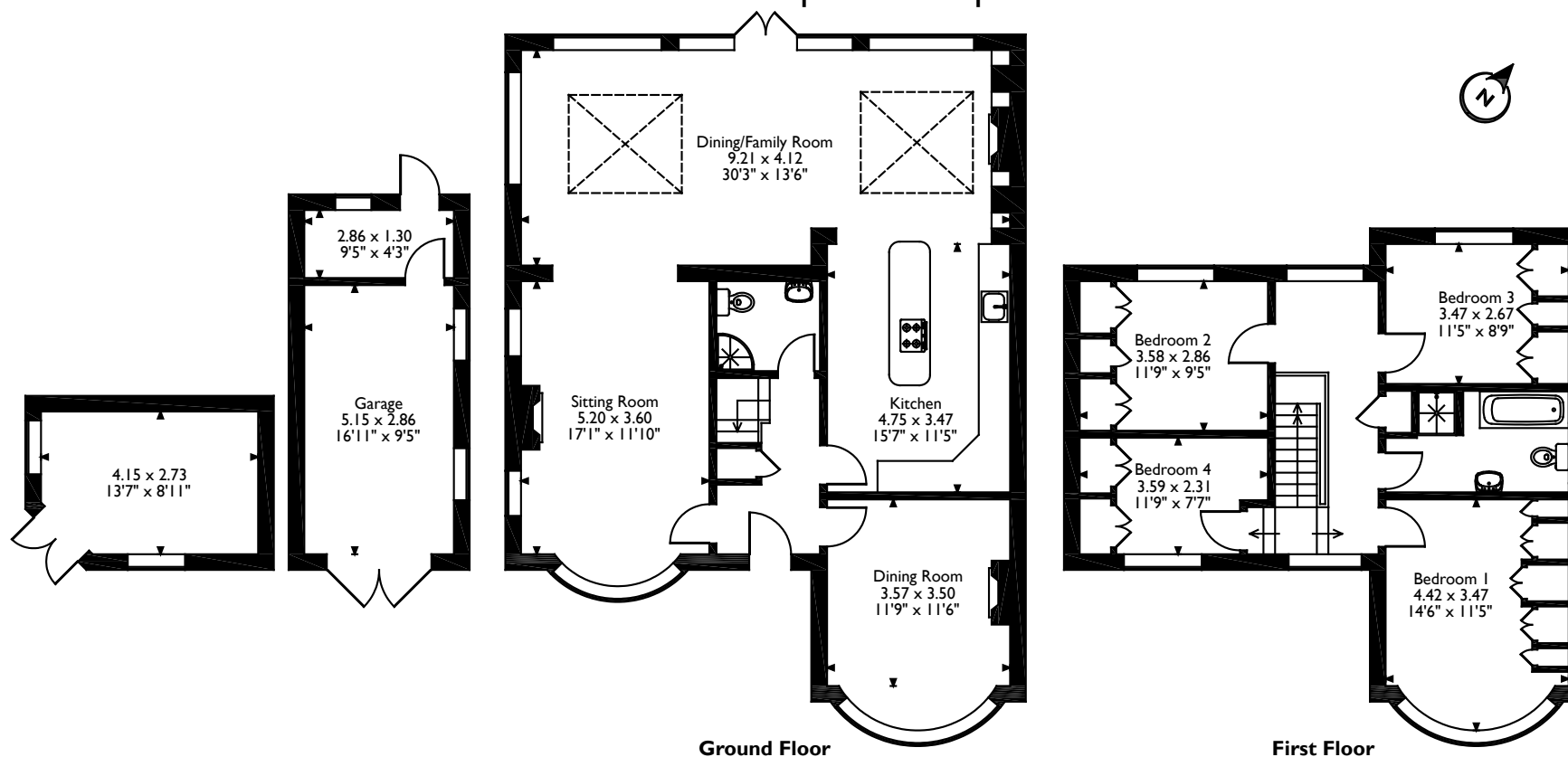

Please note that the location of doors, windows and other items are approximate and this floorplan is to be used for illustrative purposes only. Unauthorized reproduction is prohibited.

ROBSONS

The Estate Office, North Approach, Moor Park, Middlesex HA6 2JQ

Tel: 01923 820622 moorpark@robsonswb.com

www.robsonswb.com

Important notice: Robsons, their clients and any joint agents give notice that 1: They are not authorised to make or give any representations or warranties in relation to the property either here or elsewhere, either on their own behalf or on behalf of their client or otherwise. They assume no responsibility for any statement that may be made in these particulars. These particulars do not form part of any offer or contract and must not be relied upon as statements or representations of fact. 2: Any areas, measurements or distances are approximate. Plot sizes and dimensions are taken from Promap and are approximate. The text, photographs and plans are for guidance only and are not necessarily comprehensive. It should not be assumed that the property has all necessary planning, building regulation or other consents and Robsons have not tested any services, equipment or facilities. Purchasers must satisfy themselves by inspection or otherwise.