



## A MODERN FOUR BEDROOM CHALET BUNGALOW

Kenilworth Drive, Croxley Green, Rickmansworth WD3 3NW

**ROBSONS**



## A MODERN FOUR BEDROOM CHALET BUNGALOW

Kenilworth Drive, Croxley Green, Rickmansworth  
WD3 3NW

- KITCHEN/BREAKFAST ROOM
- SITTING ROOM
- DINING ROOM
- GROUND FLOOR BATHROOM WITH SEPARATE WC
- MASTER BEDROOM WITH EN-SUITE SHOWER ROOM
- TWO FURTHER BEDROOMS
- REAR GARDEN
- GARAGE
- OWN DRIVEWAY

### Description

A contemporary four bedroom, two bathroom chalet bungalow situated within the picturesque Croxley Green. The property has been refurbished to a high standard and offers bright and spacious accommodation throughout. The property briefly comprises a dining room, sitting room, modern kitchen/breakfast room, ground floor bedroom, bathroom and separate WC. To the first floor, there is a master bedroom with en-suite shower room and two further bedrooms.







Further benefits include a well maintained rear garden, own driveway and a single garage.

### Location

Picturesque Croxley Green provides the perfect backdrop as it offers village charm in the rural suburbs of Hertfordshire. The property is within easy reach of Croxley Green and Rickmansworth town centre with its wide range of boutique shops, coffee houses, restaurants and the major supermarkets. The Metropolitan and Chiltern line train services connects you to London Baker Street, Marylebone Station and beyond. The M25 motorway is available at both junction 17 and 18 connecting you to the national motorway network. Major London airports are also within reach. The area is well served for good quality private and state schools for all ages.

### Additional Information

Guide Price: Price on Application

Tenure: Freehold

Local Authority: Three Rivers District Council

Energy Efficiency Rating: Band E





Approximate Gross Internal Area  
 Ground Floor = 70.4 sq m / 758 sq ft  
 First Floor = 38.9 sq m / 419 sq ft  
 Garage = 16.7 sq m / 180 sq ft  
 Total = 126.0 sq m / 1357 sq ft

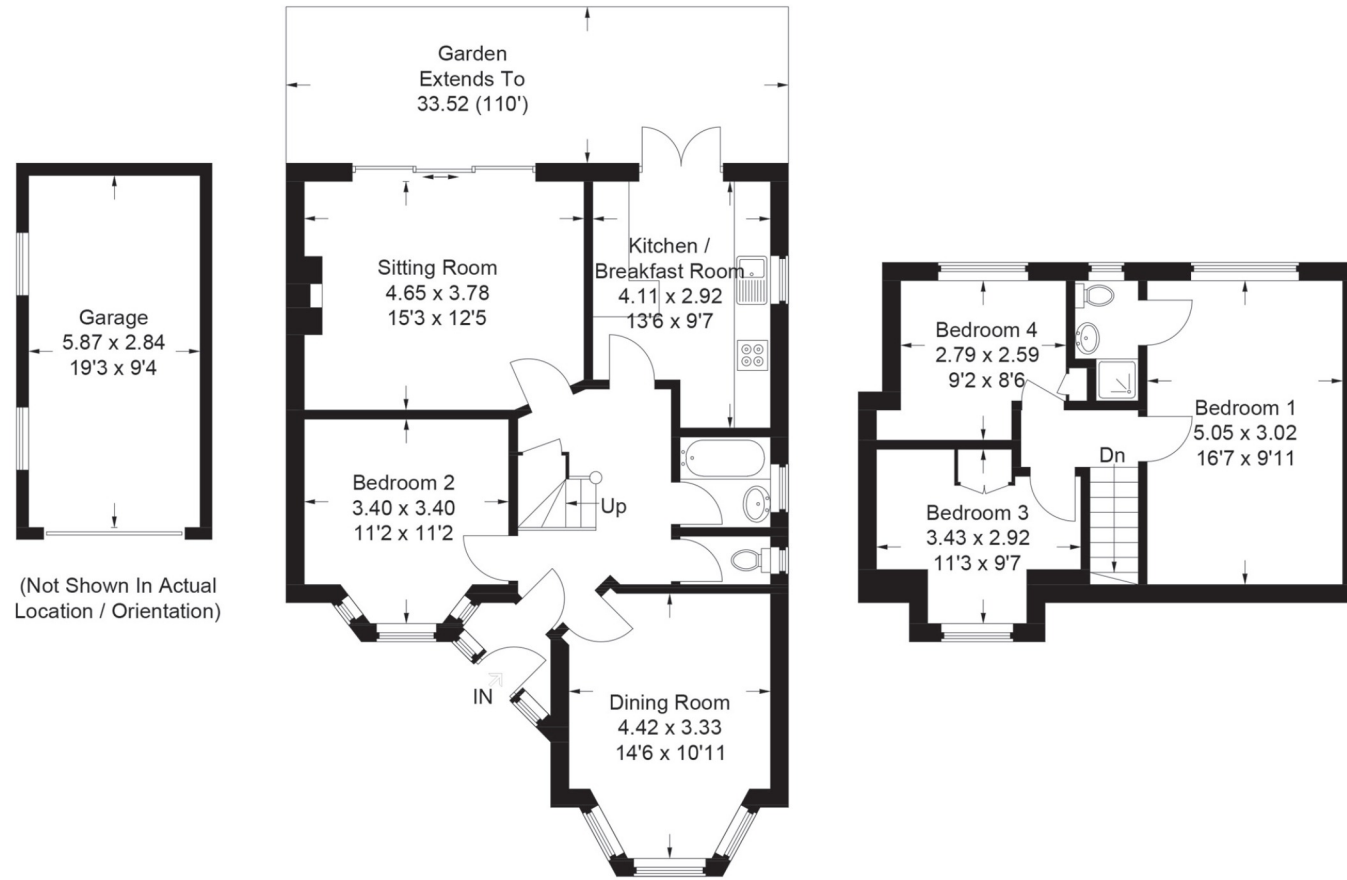

### Ground Floor

### First Floor

This plan is for layout guidance only. Not drawn to scale unless stated. Windows and door openings are approximate. Whilst every care is taken in the preparation of this plan, please check all dimensions, shapes and compass bearings before making any decisions reliant upon them.

© CJ Property Marketing Ltd Produced for Robsons

# ROBSONS

Address: 130 High Street, Rickmansworth, Hertfordshire, WD3 1AB  
 Tel: 01923 777 762 Email: Rickmansworth@robsonswb.com

[www.robsonswb.com](http://www.robsonswb.com)

[www.the-londonoffice.co.uk](http://www.the-londonoffice.co.uk)  
 40 ST JAMES'S PLACE SW1

Important notice: Robsons, their clients and any joint agents give notice that 1: They are not authorised to make or give any representations or warranties in relation to the property either here or elsewhere, either on their own behalf or on behalf of their client or otherwise. They assume no responsibility for any statement that may be made in these particulars. These particulars do not form part of any offer or contract and must not be relied upon as statements or representations of fact. 2: Any areas, measurements or distances are approximate. Plot sizes and dimensions are taken from Promap and are approximate. The text, photographs and plans are for guidance only and are not necessarily comprehensive. It should not be assumed that the property has all necessary planning, building regulation or other consents and Robsons have not tested any services, equipment or facilities. Purchasers must satisfy themselves by inspection or otherwise.