



A WELL PRESENTED TWO BEDROOM VICTORIAN COTTAGE

Neal Street, Watford, Hertfordshire, WD18 0AX

ROBSONS

A WELL PRESENTED TWO BEDROOM VICTORIAN COTTAGE

Neal Street, Watford, Hertfordshire, WD18 0AX

- TWO RECEPTION ROOMS
- KITCHEN
- TWO BEDROOMS
- FAMILY BATHROOM
- REAR GARDEN
- CLOSE TO TOWN CENTRE
- EXCELLENT TRAIN-LINKS
- NO ONWARD CHAIN

Description

A well maintained two bedroom Victorian cottage, situated within close proximity to Watford town centre and Watford High Street Station. The property is dressed in neutral tones throughout and boasts period features including original wooden flooring and feature fireplaces. The cottage briefly comprises a modern fitted kitchen, two reception rooms, two bedrooms, a family bathroom and a low maintenance rear garden.





Location

Watford town centre is within close proximity to this attractive home with its comprehensive array of shops and restaurants, including the Intu centre. Transport facilities include the main line to Euston from Watford Junction and the Metropolitan Line station with access to Baker Street and the City. Access to the M25 and M1 are close by. There is an excellent selection of schools both private and state including Watford Boys and Girls Grammar Schools and York House Prep School.

Additional Information

Version 2.

Guide Price: Price on Application

Tenure: Freehold

Local Authority: Watford Council

Energy Efficiency Rating: Band D



Approximate Gross Internal Area
 Ground Floor = 31.1 sq m / 335 sq ft
 First Floor = 29.0 sq m / 312 sq ft
 Total = 60.1 sq m / 647 sq ft

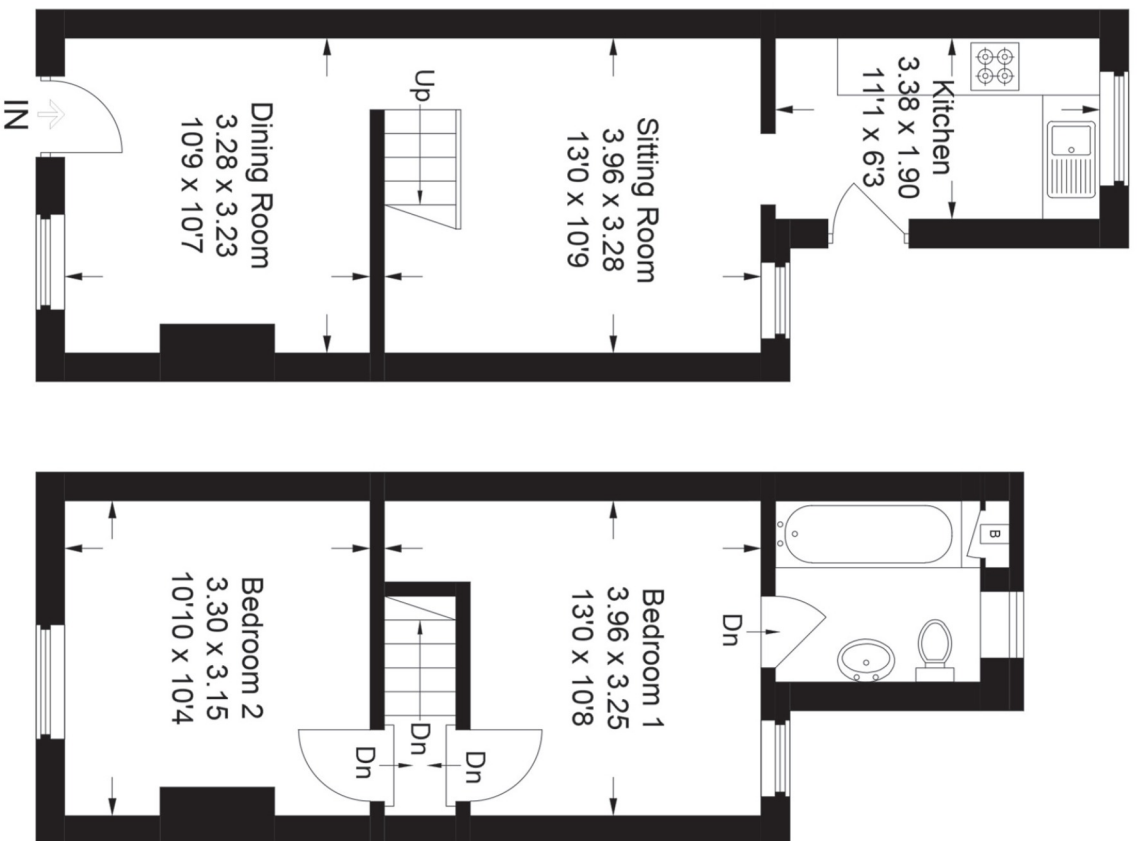

This plan is for layout guidance only. Not drawn to scale unless stated. Windows and door openings are approximate. Whilst every care is taken in the preparation of this plan, please check all dimensions, shapes and compass bearings before making any decisions reliant upon them.

© CJ Property Marketing Ltd Produced for Robsons



Address: 130 High Street, Rickmansworth, Hertfordshire, WD3 1AB
 Tel: 01923 777 762 Email: Rickmansworth@robsonsweb.com

www.robsonsweb.com

www.the-londonoffice.co.uk
 40 ST JAMES'S PLACE SW1

Important notice: Robsons, their clients and any joint agents give notice that 1: They are not authorised to make or give any representations or warranties in relation to the property either here or elsewhere, either on their own behalf or on behalf of their client or otherwise. They assume no responsibility for any statement that may be made in these particulars. These particulars do not form part of any offer or contract and must not be relied upon as statements or representations of fact. 2: Any areas, measurements or distances are approximate. Plot sizes and dimensions are taken from Promap and are approximate. The text, photographs and plans are for guidance only and are not necessarily comprehensive. It should not be assumed that the property has all necessary planning, building regulation or other consents and Robsons have not tested any services, equipment or facilities. Purchasers must satisfy themselves by inspection or otherwise.