



A well-presented and modern three bedroom family home in a popular location
Vivian Close, Watford, WD19 4PQ

ROBSONS

Asking Price: £2,350 pcm

A well-presented and modern three bedroom family home in a popular location

Vivian Close, Watford, WD19 4PQ

• ENTRANCE HALL • LOUNGE/DINING ROOM • KITCHEN • CONSERVATORY • THREE BEDROOMS TWO WITH FITTED WARDROBES • SHOWER ROOM • REAR GARDEN • OFF STREET PARKING • UNFURNISHED

Description

A well-presented and modern three bedroom family home in a popular location in Watford. The semi-detached property comprises, lounge & dining area, modern fitted kitchen with appliances and a conservatory overlooking the garden. On the first floor are two double bedrooms, a single bedroom and family shower room. Off-street parking for two vehicles is provided via a front driveway and there is a well-manicured garden and decking area to the rear.

** An advance reservation payment of one weeks rent is required to secure this property**

Location

Vivian Close is situated in Oxhey Hall close to the town centres of Oxhey and Watford which have plenty of shops, restaurants and amenities. Bushey and Watford train stations are nearby offering access into central London, whilst nearby is the M25 and M1 Motorways which provide easy access to the national motorway network.





Additional Information

- Local Authority: Three Rivers
- Council Tax Band: D
- Deposit Amount: £2,711.00
- Reservation Payment: One weeks Rent
- Energy Efficiency Rating: Band B
- Available Date: 27/07/2026

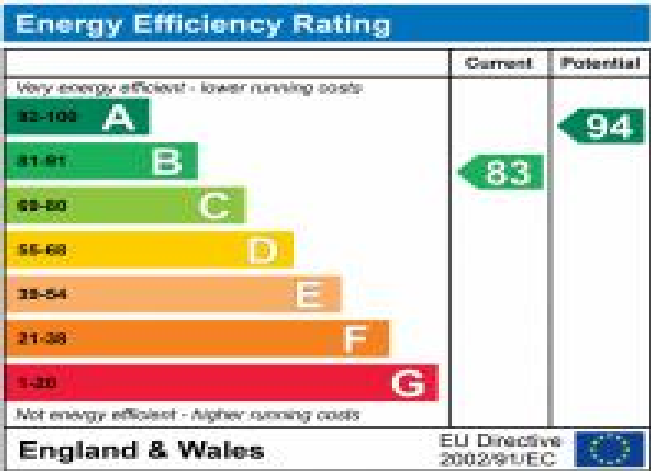

Vivian Close, Watford, Hertfordshire, WD19 4PQ
Approximate Gross Internal Area
91 Sq M/980 Sq Ft

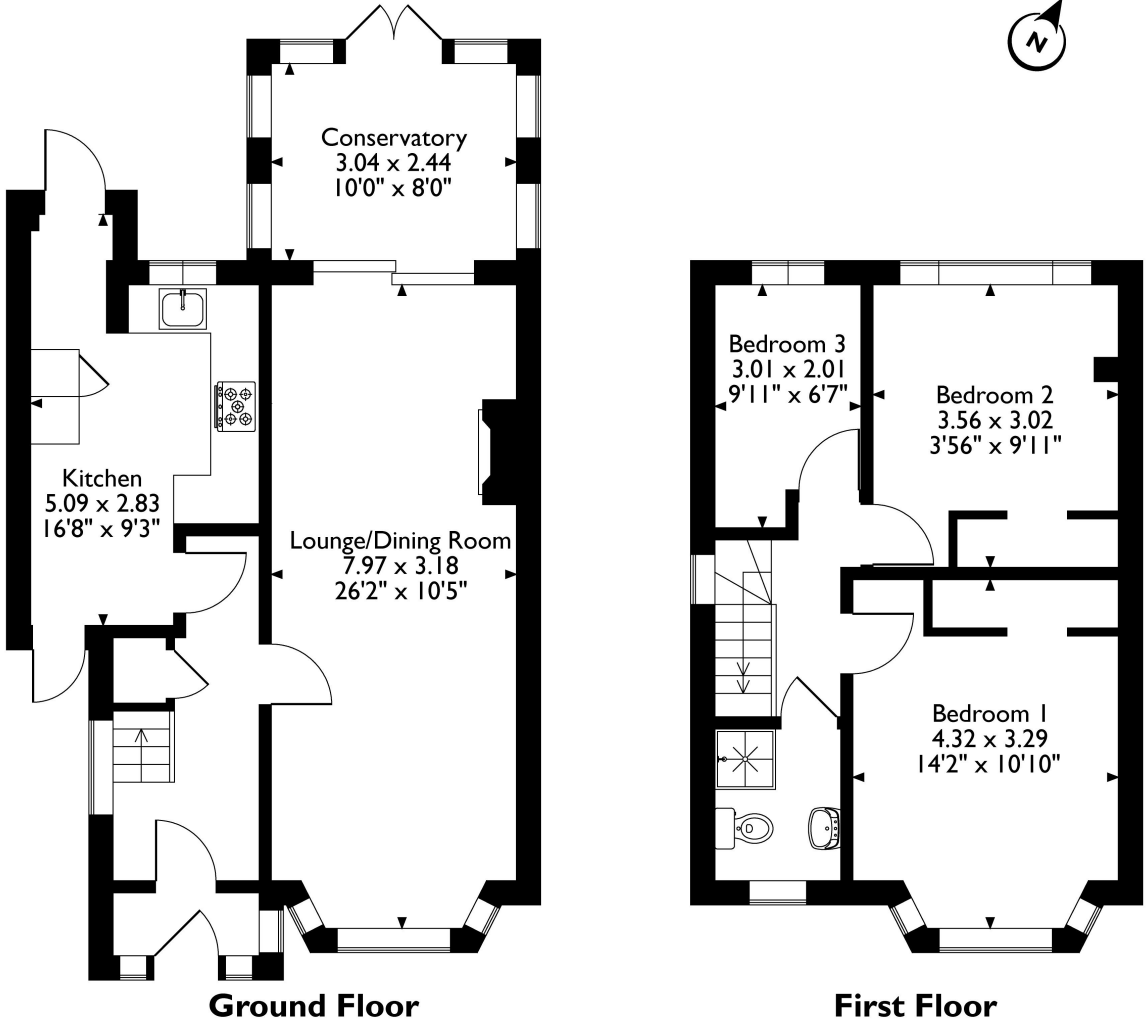

Please note that the location of doors, windows and other items are approximate and this floorplan is to be used for illustrative purposes only. Unauthorized reproduction is prohibited.



REGISTERED OFFICE 2-4 PACKHORSE ROAD, GERRARDS CROSS, BUCKINGHAMSHIRE, ENGLAND, SL9 7QE. COMPANY NO. 07557114. VAT NO. GB211239453