



A one bedroom duplex maisonette with allocated parking space  
Myrtleside Close, Northwood, HA6 2XH

**ROBSONS**



**Asking Price: £1,500 pcm**

## **A one bedroom duplex maisonette with allocated parking space**

Myrtleside Close, Northwood, HA6 2XH

- 
- ENTRANCE HALL AND STAIRS TO FIRST FLOOR •
  - LIVING/DINING ROOM • KITCHEN • SECOND FLOOR -
  - BEDROOM • BATHROOM • FITTED CUPBOARDS IN HALLWAY •
  - ALLOCATED PARKING SPACE TO FRONT • UNFURNISHED
- 

### **Description**

A very well presented one bedroom duplex maisonette located in the heart of Northwood. The property consists of entrance hall, living room, kitchen with fitted appliances, bedroom and wardrobe storage. The property also benefits from allocated off-street parking.

**\*\* An advance reservation payment of one weeks rent is required to secure the property \*\***

### **Location**

Northwood provides a range of shopping facilities including a Waitrose supermarket, a variety of restaurants and other amenities with the Metropolitan Line station providing access to Baker Street and the City. There is a plethora of state and private schooling together with a wide choice of recreational facilities, which include golf courses and fitness centres. The M1, M40 and M25 motorways are also accessible.





**Additional Information**

- Local Authority: Hillingdon
- Council Tax Band: C
- Deposit Amount: £1,730.00
- Reservation Payment: One weeks rent
- Energy Efficiency Rating: Band C
- Available Date: 01/08/2024

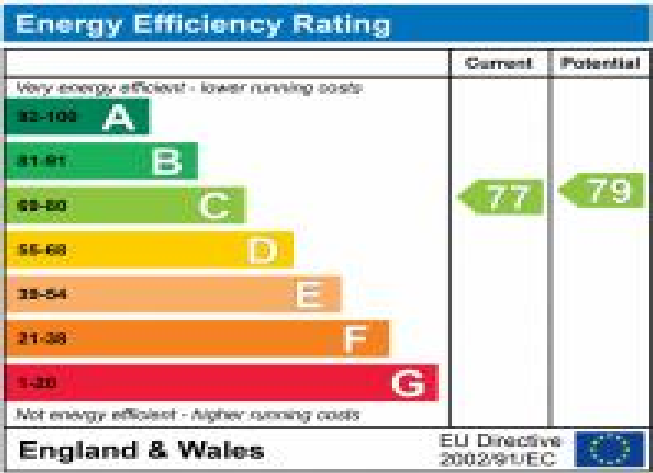

# Myrtleside Close, Northwood, Middlesex, HA6 2XH

## Approximate Gross Internal Area 54 Sq M/582 Sq Ft

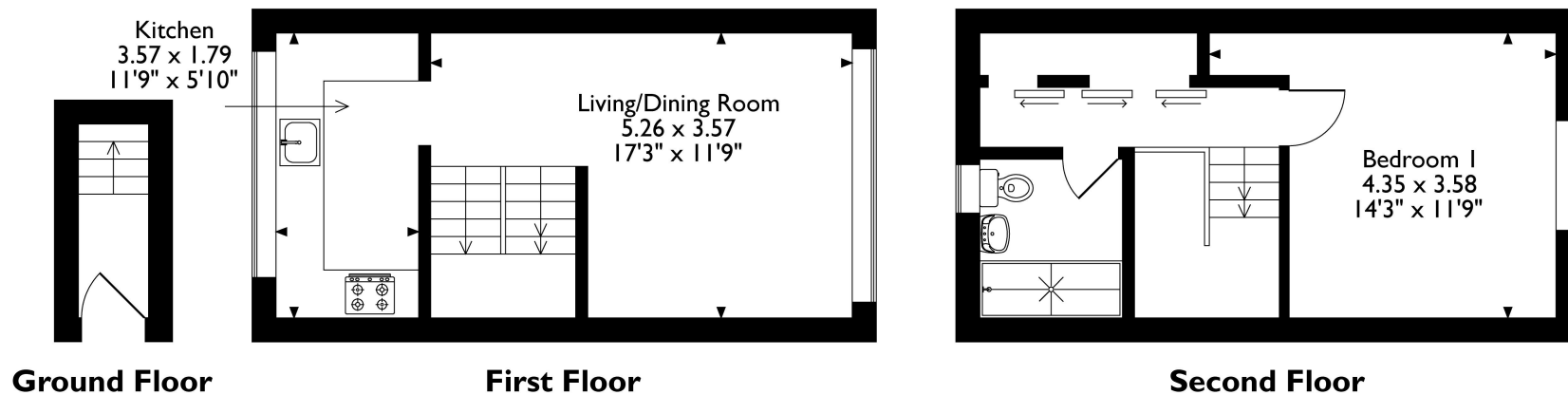

Please note that the location of doors, windows and other items are approximate and this floorplan is to be used for illustrative purposes only. Unauthorized reproduction is prohibited.

