



A charming, rarely available four bedroom, two bathroom detached family home  
Old Hall Close, Pinner, HA5 4ST





**Asking Price: £4,000 pcm**

## **A charming, rarely available four bedroom, two bathroom detached family home**

Old Hall Close, Pinner, HA5 4ST

---

• ENTRANCE HALLWAY • OPEN PLAN KITCHEN/BREAKFAST ROOM • TWO RECEPTION ROOMS • CONSERVATORY • DOWNSTAIRS GUEST CLOAKROOM WITH SHOWER • FOUR BEDROOMS • DOUBLE LENGTH GARAGE • FRONT AND REAR GARDEN • OFF STREET PARKING VIA OWN DRIVEWAY • UNFURNISHED

---

### **Description**

A charming, rarely available four bedroom, two bathroom, detached family home situated in a sought after road off St Thomas Drive. The property comprises of entrance hallway, two reception rooms, downstairs guest cloakroom with shower, conservatory, open plan kitchen/sitting room leading on to a beautiful landscaped garden. The first floor comprises of four bedrooms, separate guest cloakroom and a family bathroom. The property is offered unfurnished with off street parking for several cars and a double length garage.

**\*\*A holding deposit of £1096 is required to secure this property, this is equivalent to one weeks deposit\*\***

### **Location**

Conveniently situated for both Hatch End and Pinner high streets where you can find a variety of shopping facilities, coffee houses, restaurants and popular supermarkets. For commuters, there are excellent transport facilities nearby with the Overground services available at Hatch End station and the Metropolitan Line at Pinner station, both providing regular links into the City. The area is well served by local primary and secondary schooling, children's play areas and recreational facilities.







**Additional Information**

- Local Authority: Harrow
- Council Tax Band: G
- Deposit Amount: £6,576.00
- Reservation Payment: One weeks rent
- Energy Efficiency Rating: Band C
- Available Date: 28/10/2024

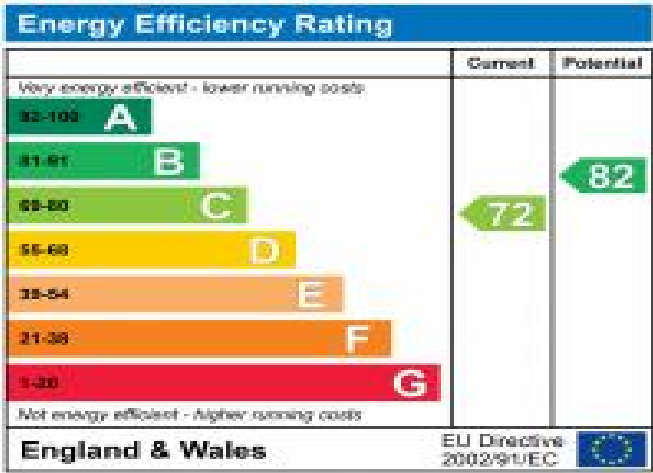

Old Hall Close, Pinner, Hertfordshire  
 Approximate Gross Internal Area  
 Main House = 153 Sq M/1647 Sq Ft  
 Garage = 27 Sq M/291 Sq Ft  
 Total = 180 Sq M/1938 Sq Ft

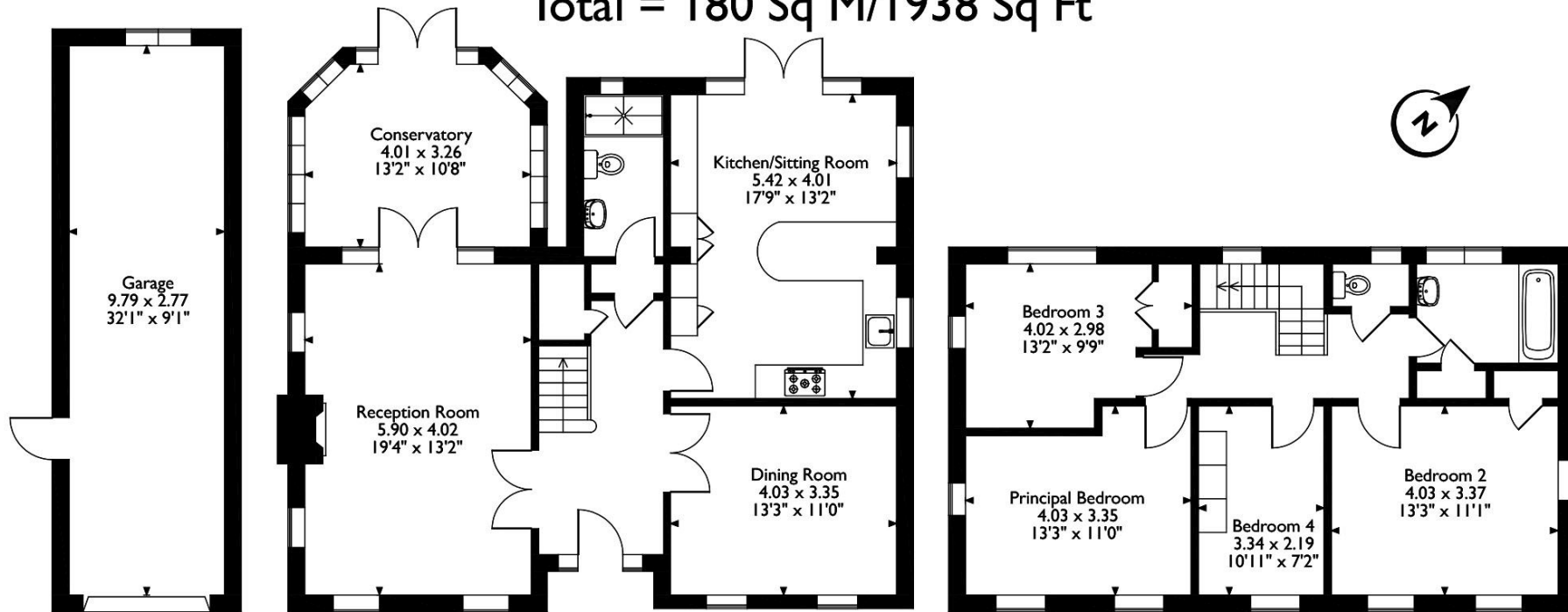

**Ground Floor**

**First Floor**

Please note that the location of doors, windows and other items are approximate and this floorplan is to be used for illustrative purposes only. Unauthorized reproduction is prohibited.



REGISTERED OFFICE 2-4 PACKHORSE ROAD, GERRARDS CROSS, BUCKINGHAMSHIRE, ENGLAND, SL9 7QE. COMPANY NO. 07557114. VAT NO. GB211239453