



A unique grade II listed property
Batchworth Heath, Rickmansworth, Herts WD3 1QB



Asking Price: £1,750 pcm

A unique grade II listed property

Batchworth Heath, Rickmansworth, Herts WD3 1QB

• GRADE II LISTED BUILDING • SITTING ROOM • DINING ROOM • KITCHEN • TWO BEDROOMS • BATHROOM • ANNEXE WITH BEDROOM, WC & UTILITY • GARDEN • OFF STREET PARKING • UNFURNISHED

Description

A unique grade II listed property located within the grounds of the prestigious 17th Century Moor Park Mansion and Golf Club offering a tranquil and secluded address. The impressive accommodation briefly comprises two reception rooms, kitchen, two bedrooms and bathroom. There is an annexe offering a further bedroom, WC and utility. The property is surrounded by landscaped gardens and off street parking is provided for several vehicles

Location

Batchworth Heath exudes an air of country living, surrounded by farm land yet has all the benefits of life in the metropolis close at hand. Both town centres provide a wide choice of boutique shops, restaurants, coffee Houses and major supermarkets. Recreational facilities caters for those enjoying a sporting life, with major golf courses, cricket clubs and well renowned fitness centres. There are also excellent private and state schools for children of all ages. Connections to the heart of the capital are straightforward, with regular underground services provided by the Metropolitan line, putting Baker Street within reach. Airports and major motorway links are also accessible.





Additional Information

- Local Authority: Three Rivers District Council
- Council Tax Band: F
- Available Date: 31/03/2020



Batchworth Heath, Rickmansworth, WD3

APPROX. GROSS INTERNAL FLOOR AREA 1216 SQ FT 112.9 SQ METRES (INCLUDES ANNEXE)

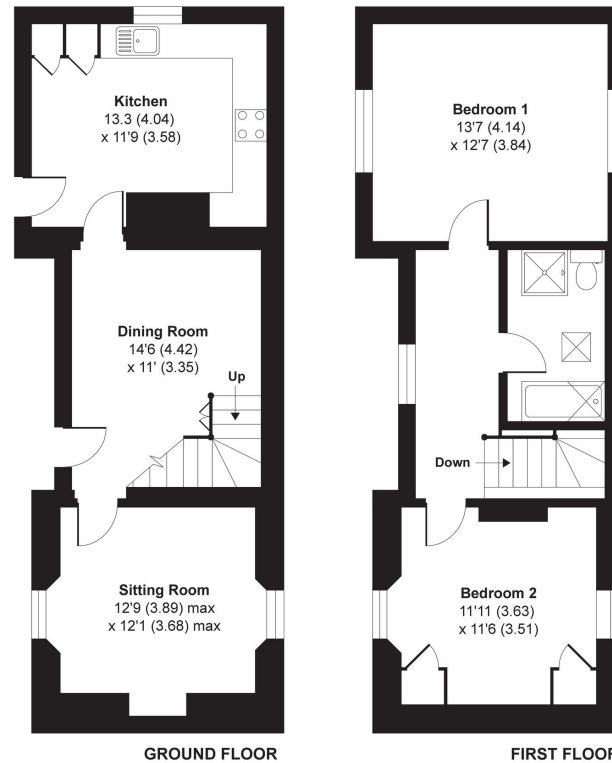
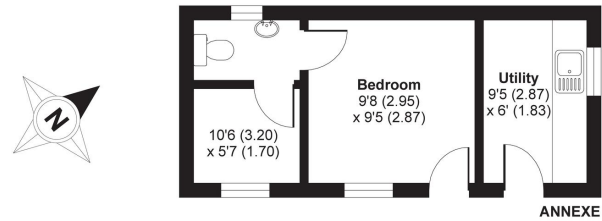

Whilst every attempt has been made to ensure the accuracy of the floor plan contained here, measurements of doors, windows and rooms are approximate and no responsibility is taken for any error, omission or misstatement. These plans are for representation purposes only as defined by RICS Code of Measuring Practice and should be used as such by any prospective purchaser. Specifically no guarantee is given on the total square footage of the property if quoted on this plan. Any figure given is for initial guidance only and should not be relied on as a basis of valuation.

Copyright nichecom.co.uk 2019 Produced for Robsons Lettings REF : 501147

ROBSONS

3 Maxwell Road, Northwood, Middlesex HA6 2XY
T: 01923 822211 F: 01923 820783 E: lettings@robsonswb.com



Robsons Residential Lettings Limited is a company registered in England and Wales and its registered office is at 23 Church Street, Rickmansworth, Hertfordshire WD3 1DE
Registered Number - 07557114 VAT Registered No - 211 239 453