



A well presented and spacious two bedroom apartment
Eastbury Place, Northwood, Middlesex HA6 3LQ

ROBSONS

Asking Price: £1,900 pcm

A well presented and spacious two bedroom apartment

Eastbury Place, Northwood, Middlesex HA6 3LQ

• FIRST FLOOR • TWO BEDROOMS • LIVING ROOM • KITCHEN •
BATHROOM • GARAGE • RESIDENTS PARKING • UNFURNISHED

Description

A very well presented and spacious two bedroom apartment located on a popular location in Northwood. The property comprises , entrance hall, living room, kitchen with appliances, two double bedrooms and a family bathroom. The property also benefits from communal gardens, residents car park and a private garage in a nearby block.

**** An advance reservation payment of one weeks rent is required to secure the property ****

Location

Northwood provides a range of shopping facilities including a Waitrose supermarket, a variety of restaurants and other amenities with the Metropolitan Line station providing access to Baker Street and the City. There is a plethora of state and private schooling together with a wide choice of recreational facilities, which include golf courses and fitness centres. The M1, M40 and M25 motorways are also accessible.





Additional Information

- Local Authority: Three Rivers
- Council Tax Band: E
- Deposit Amount: £2,192.00
- Reservation Payment: One weeks rent
- Energy Efficiency Rating: Band C
- Available Date: 18/04/2025

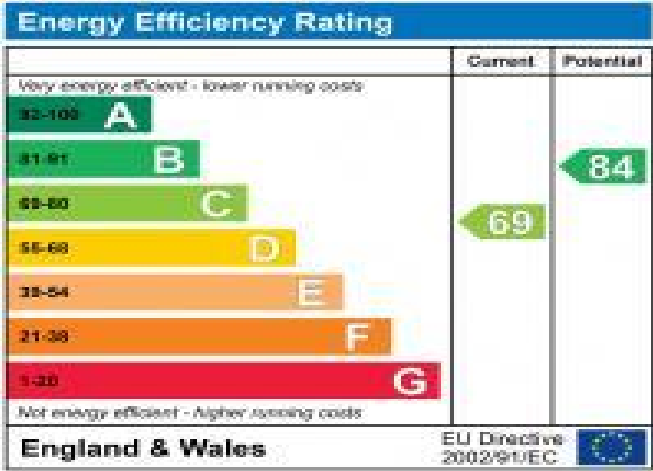

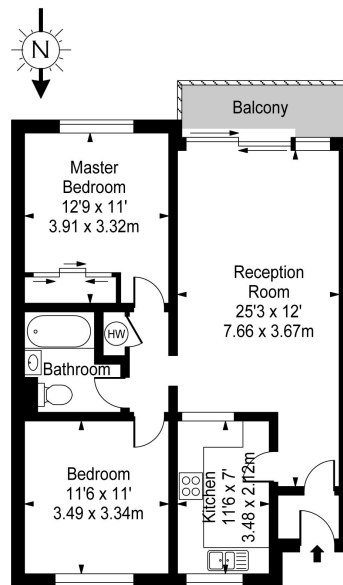

Second Floor

Approx. Gross Internal Area 752 Sq Ft - 69.86 Sq M

For Illustration Purposes Only - Not To Scale Floor Plan by www.pmsupply.co.uk Ref: No. 26753

This floor plan should be used as a general outline for guidance only and do not constitute in whole or in part an offer or contract.
Any intending purchaser or lessee should satisfy themselves by inspection, searches, enquiries and full survey as to the correctness of each statement.
Any areas, measurements or distances quoted are approximate and should not be used to value a property or be the basis of any sale or let.

