



A two bedroom two bathroom apartment close to Northwood town centre
Dell Court, Northwood, Middlesex HA6 2UT

ROBSONS

Asking Price: £2,050 pcm

A two bedroom two bathroom apartment close to Northwood town centre

Dell Court, Northwood, Middlesex HA6 2UT

• ENTRANCE HALL • LIVING ROOM WITH BALCONY • KITCHEN/DINING ROOM • MAIN BEDROOM WITH ENSUITE SHOWER ROOM • BEDROOM TWO • BATHROOM • COMMUNAL GROUNDS • ALLOCATED PARKING SPACE • PART FURNISHED

Description

A spacious two bedroom, two bathroom second floor apartment located in a secure gated development, just a short walk from Northwood High Street and Metropolitan Line train station. The property comprises an entrance hall, a master bedroom with an ensuite shower room, and a second well-sized bedroom. The large kitchen/dining room offers ample space for entertaining, while the generous living room benefits from a private balcony. Additional features include useful hallway storage cupboards. The apartment also comes with an allocated parking space for added convenience.

**** An advance reservation payment of one weeks rent is required to secure the property ****

Location

Northwood provides a range of shopping facilities including a Waitrose supermarket, a variety of restaurants and other amenities with the Metropolitan Line station providing access to Baker Street and the City. There is a plethora of state and private schooling together with a wide choice of recreational facilities, which include golf courses and fitness centres. The M1, M40 and M25 motorways are also accessible.





Additional Information

- Local Authority: Hillingdon
- Council Tax Band: F
- Deposit Amount: £2,365.00
- Reservation Payment: One weeks rent
- Energy Efficiency Rating: Band B
- Available Date: 05/12/2024

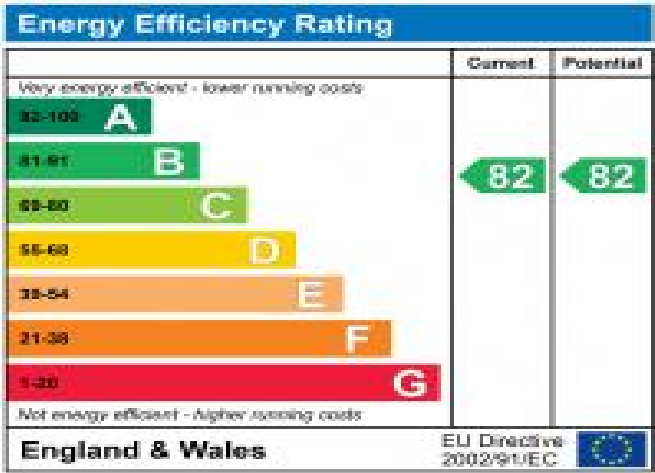

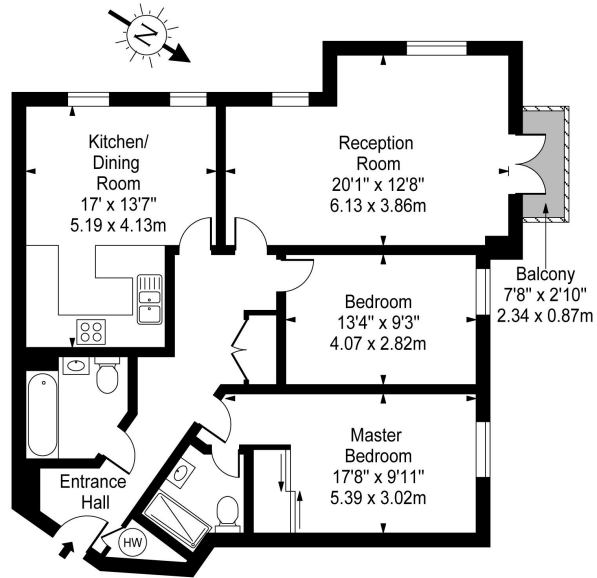

Second Floor

Approx. Gross Internal Area 1035 Sq Ft - 96.16 Sq M

For Illustration Purposes Only - Not To Scale Floor Plan by www.pmsupply.co.uk Ref: No. 29209

This floor plan should be used as a general outline for guidance only and do not constitute in whole or in part an offer or contract.
Any intending purchaser or lessee should satisfy themselves by inspection, searches, enquiries and full survey as to the correctness of each statement.
Any areas, measurements or distances quoted are approximate and should not be used to value a property or be the basis of any sale or let.

