



A generous three bedroom, two bathroom first floor apartment  
Marchbank House, Northwood, Middlesex HA6 2SG





**Asking Price: £2,750 pcm**

## **A generous three bedroom, two bathroom first floor apartment**

Marchbank House, Northwood, Middlesex HA6 2SG

---

• COMMUNAL ENTRANCE HALL • STAIRS AND LIFT TO FIRST FLOOR • COMMUNAL GROUNDS • SITTING/DINING ROOM • FITTED KITCHEN • MASTER BEDROOM WITH EN-SUITE SHOWER ROOM • TWO FURTHER BEDROOMS • BATHROOM • TWO ALLOCATED PARKING SPACES • FURNISHED/UNFURNISHED

---

### **Description**

A generous three bedroom, two bathroom, purpose built first floor apartment set within a gated development situated within convenient proximity to Northwood town centre. The property comprises of entrance hall, kitchen, reception room, master bedroom with ensuite shower, two further bedrooms and a family bathroom. The property enjoys South Easterly views over the communal gardens and benefits from two allocated parking spaces.

**\*\* An advance reservation payment of one weeks rent is required to secure this property\*\***

### **Location**

Northwood provides a range of shopping facilities, a Waitrose supermarket, restaurants and the Metropolitan Line Station providing access to Baker Street and the city beyond. The area has a range of both private and state schools, places of worship and recreational facilities are also well catered for in the surrounding area and major motorway links to M25 and M1 are nearby.





### Additional Information

- Local Authority: London Borough of Hillingdon
- Council Tax Band: F
- Deposit Amount: £3,173.00
- Reservation Payment: One weeks rent
- Energy Efficiency Rating: Band B
- Available Date: 04/08/2025

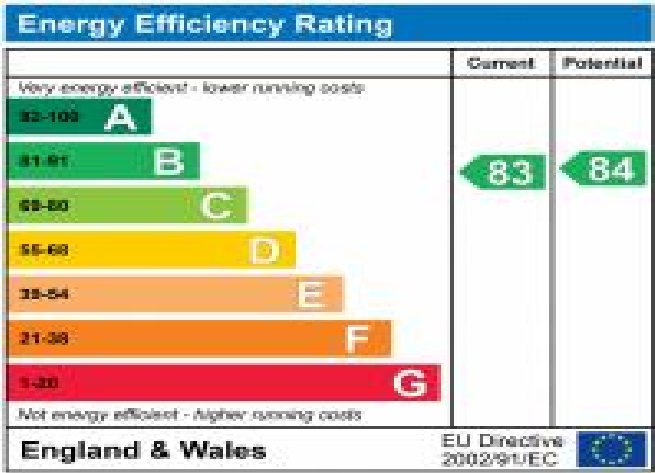



APPROX. GROSS INTERNAL FLOOR AREA 1154 SQ FT 107 SQ METRES

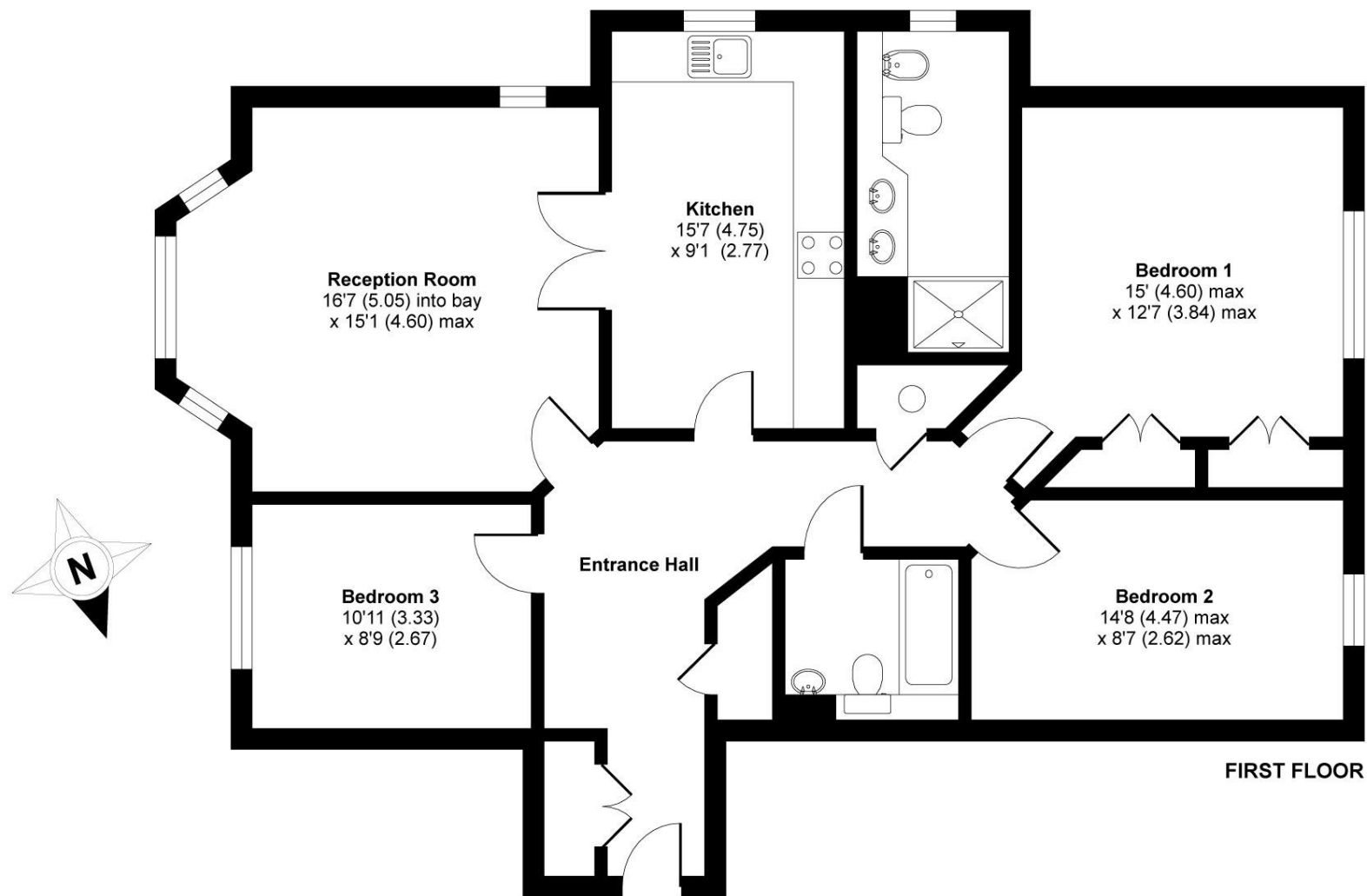

'For illustrative purposes only - not to scale. The position and size of doors, windows, appliances and other features are approximate only.'

Whilst every attempt has been made to ensure the accuracy of the floor plan contained here, measurements of doors, windows and rooms are approximate and no responsibility is taken for any error, omission or misstatement. These plans are for representation purposes only as defined by RICS Code of Measuring Practice and should be used as such by any prospective purchaser. Specifically no guarantee is given on the total square footage of the property if quoted on this plan. Any figure given is for initial guidance only and should not be relied on as a basis of valuation.

Copyright nichecom.co.uk 2015 Produced for Robsons REF : 10365



REGISTERED OFFICE 2-4 PACKHORSE ROAD, GERRARDS CROSS, BUCKINGHAMSHIRE, ENGLAND, SL9 7QE. COMPANY NO. 07557114. VAT NO. GB211239453