



A charming two double bedroom mid-terrace character cottage
High Street, Northwood, Middlesex HA6 1ED

ROBSONS

Asking Price: £1,300 pcm

A charming two double bedroom mid-terrace character cottage

High Street, Northwood, Middlesex HA6 1ED

• RECEPTION ROOM • DINING ROOM • KITCHEN • TWO DOUBLE BEDROOMS • BATHROOM • OFF STREET PARKING TO THE FRONT • REAR GARDEN • GAS CENTRAL HEATING • UNFURNISHED

Description

Positioned conveniently close to the centre of Northwood, this charming two double bedroom mid-terrace character cottage offers spacious accommodation over two floors. Presented in excellent order throughout and boasting off street parking to the front and attractive rear garden. Internal viewing is recommended to appreciate the size and layout of the accommodation.

Location

Northwood provides a range of shopping facilities including Waitrose supermarket, a variety of restaurants and other amenities with the Metropolitan Line station providing access to Baker Street and the City. There is a plethora of state and private schooling together with a wide choice of recreational facilities, which include golf courses and fitness centres. The M1, M40 and M25 motorways are also accessible.





Additional Information

- District Council - London Borough of Hillingdon
- Council Tax: Band E
- Energy Efficiency Rating: Band D
- Available Date: 19/10/2019

Energy Efficiency Rating			Environmental Impact (CO ₂) Rating		
	Current	Potential		Current	Potential
Very energy efficient - lower running costs			Very environmentally friendly - lower CO ₂ emissions		
(92-100) A			(92-100) A		
(81-91) B		84	(81-91) B		82
(69-80) C			(69-80) C		
(55-68) D	60		(55-68) D		
(39-54) E			(39-54) E	53	
(21-38) F			(21-38) F		
(1-20) G			(1-20) G		
Not energy efficient - higher running costs			Not environmentally friendly - higher CO ₂ emissions		
England, Scotland & Wales EU Directive 2002/91/EC			England, Scotland & Wales EU Directive 2002/91/EC		

The energy efficiency rating is a measure of the overall efficiency of a home. The higher the rating the more energy efficient the home is and the lower the fuel bills will be.

The environmental impact rating is a measure of a home's impact on the environment in terms of carbon dioxide (CO₂) emissions. The higher the rating the less impact it has on the environment.



APPROX. GROSS INTERNAL FLOOR AREA 897 SQ FT 83.3 SQ METRES

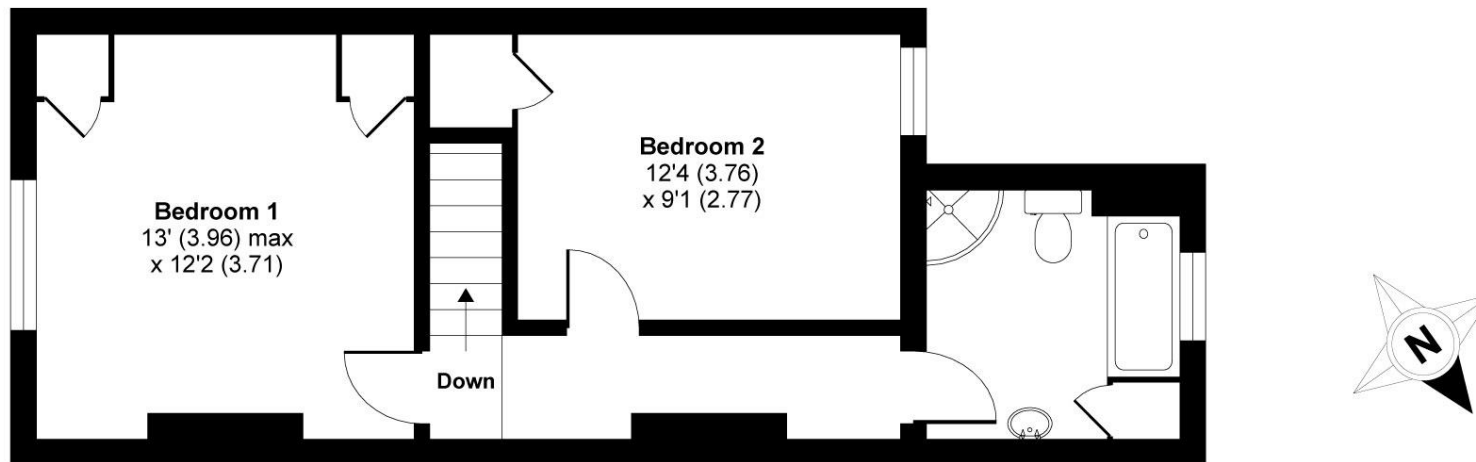

FIRST FLOOR

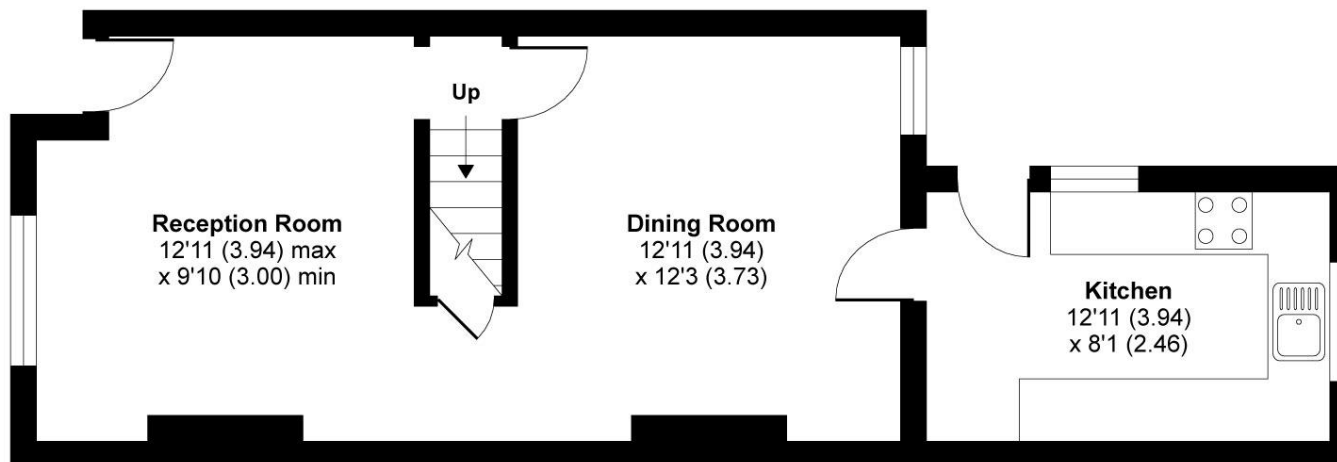

GROUND FLOOR

'For illustrative purposes only - not to scale. The position and size of doors, windows, appliances and other features are approximate only.'

Whilst every attempt has been made to ensure the accuracy of the floor plan contained here, measurements of doors, windows and rooms are approximate and no responsibility is taken for any error, omission or misstatement. These plans are for representation purposes only as defined by RICS Code of Measuring Practice and should be used as such by any prospective purchaser. Specifically no guarantee is given on the total square footage of the property if quoted on this plan. Any figure given is for initial guidance only and should not be relied on as a basis of valuation.

Copyright nichecom.co.uk 2015 Produced for Robsons REF : 23331

ROBSONS

3 Maxwell Road, Northwood, Middlesex HA6 2XY
T: 01923 822211 F: 01923 820783 E: lettings@robsonswb.com



Robsons Residential Lettings Limited is a company registered in England and Wales and its registered office is at 23 Church Street, Rickmansworth, Hertfordshire WD3 1DE
Registered Number - 07557114 VAT Registered No - 211 239 453